

RECOMMEND P.C.B LAYOUT (COMPONENT SIDE)
TOLERANCE FOR PCB LAYOUT IS ± 0.05

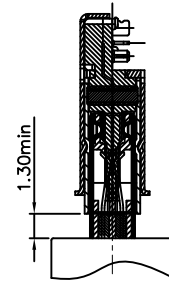
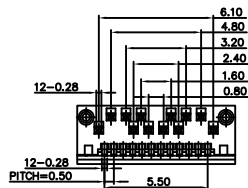

Material
 Housing Material: High temperature thermoplastic
 Contact Terminal: High Grade Copper Alloy
 Metallic Shell: Stainless Steel
 Cover Shell: Iron
 Inner Ground Cover Shell: Stainless Steel
 Mid Plate: Stainless Steel
 Plating
 Data Contact
 Underplating: 50 μ Min. Nickel
 Contact Plating: 1 μ Gold
 Solder Area: 80 μ Matte Tin
 Shell
 Metallic Shell: 50 μ Min. Nickel
 Cover Shell
 Metallic Shell: 80 μ Min. Nickel
 Inner Ground Cover Shell
 Metallic Shell: 50 μ Min. Nickel
 Electrical
 Voltage Rating: 20V DC
 Current Rating: Vbus pins collectively 5.00A, GND pins collectively 6.25A, B5 pin 1.25A, Other pins 0.25A per pin,
 Contact Resistance: 40m Ω Max.
 Insulation resistance: 100 M Ω MIN.
 Dielectric withstanding voltage: 100V AC/Minute
 Mechanical
 Durability: 10,000 cycles
 Mating Force: 5 to 20N
 Unmating Force: 8 to 20N (post test)

NO 번호	DATE 변경일자	DESCRIPTION OF REVISION 변경내용	DESIGNED 작성	CHECKED 검토	APPROVED 승인	MATERIAL 재질		SPECIFICATION 규격		FINISH 표면처리	QUANTITY 수량	SCALE 척도	
						UNIT 단위		mm					
						DESIGNED 작성	CHECKED 검토	APPROVAL 승인	DRAWING NUMBER 도번				
						김도현	박재규	최국현	PART NAME 부품명	HY-32X39	 한유안 ELECTRONICS CO.,LTD		
									MODEL NAME 제품명	HY-32X39			
DESIGNED 작성						상현전자 주식회사			3RD ANGLE PROJ	HANYONES TECH CO.,LTD		FILE. NO.	